

Size	1/4"	3/8"	1/2"	3/4"	1"	1 1/4"	1 1/2"	2"	2 1/2"	3"	4"
d	.2	.24	.32	.47	.59	.75	.95	1.26	1.50	2.44	3.07
L	1.58	1.77	2.24	2.32	2.84	3.11	3.23	3.98	4.65	6.18	6.97
H	1.14	1.26	1.65	1.54	2	2.13	2.24	2.24	2.83	4.65	5.20
W	2.76	3.15	3.54	3.78	4.84	4.84	5.59	5.91	7.09	9.25	9.25

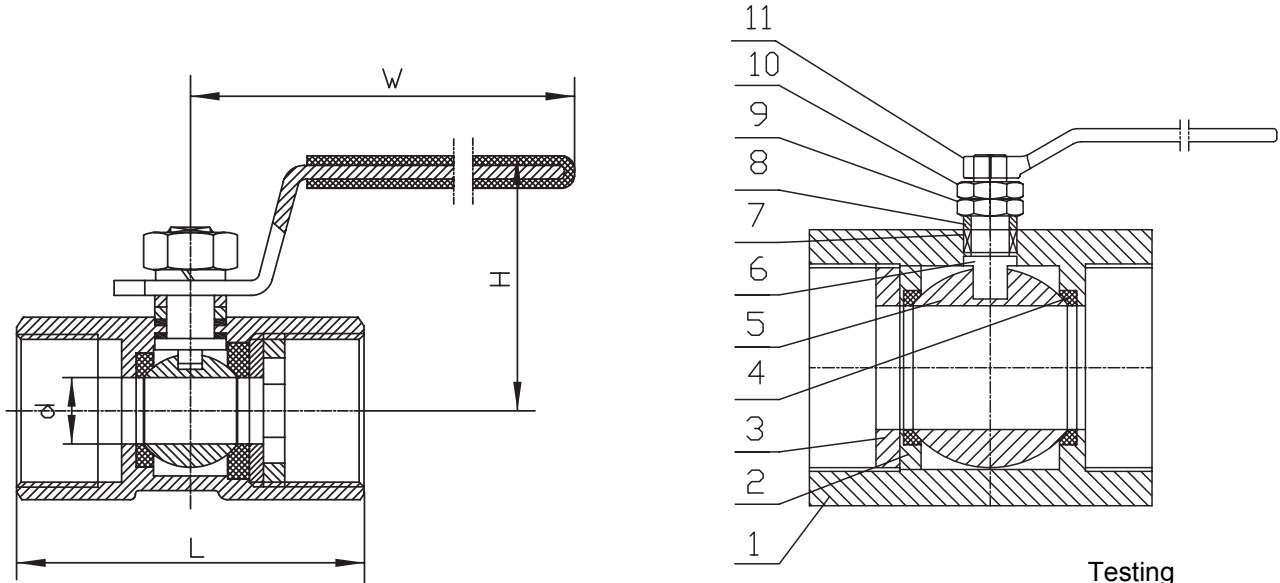

Testing
MSS-SP72
End Connection
NACE MRO 175

Materials

1	Body	304SS / 316SS
2	Washer	304SS / 316SS
3	Seat-Nuts	304SS / 316SS
4	Seat	RTFE/PTFE
5	Ball	304SS / 316SS
6	Stem	304SS / 316SS
7	Sealing	PTFE
8	Packing	RTFE/PTFE
9	Nuts	304SS / 316SS
10	Nuts	304SS / 316SS
11	Handle	304SS

Torque in/lbs

Size	1000lb
1/4"	27
3/8"	36
1/2"	54
3/4"	80
1"	124
1 1/4"	195
1 1/2"	284
2"	355
2 1/2"	532
3"	797
4"	1151

Size	1000 lb Weight	Cv
1/4"	0.15	4
3/8"	0.25	4
1/2"	0.39	10
3/4"	0.55	30
1"	0.88	49
1 1/4"	1.32	100
1 1/2"	1.77	132
2"	2.64	171
2 1/2"	7.15	220
3"	9.9	295
4"	18.7	498

VALVE SIZE	<p align="center">DIMENSIONAL DATA SHEET</p> <p align="center">BALL VALVE</p> <p align="center">SERIES 60</p> <p align="center">SIZES 1/4" - 4"</p>	PART NO.	
PRESSURE RATING		DRAWING NO.	REV
CUSTOMER/PROJECT		FL60-001	A
INQ/PO NO.		DATE	
ORDER NO.		7/09	
CERTIFIED BY DATE			