

Size	A	B	C	D3	N	M	a°	NxN	L1	Wgt
2"	5.63	2.87	1.63	4.75	5/8-11	4	45°	0.551	0.79	10
2 1/2"	6.14	3.15	1.77	5.5	5/8-11	4	45°	0.551	0.79	11
3"	6.38	3.39	1.75	6	5/8-11	4	45°	0.551	0.79	12
4"	7.13	4.06	2	7.5	5/8-11	8	22.5°	0.551	0.79	20
5"	7.76	4.72	2.13	8.5	3/4-10	8	22.5°	0.67	0.95	25
6"	8.27	5.12	2.13	9.5	3/4-10	8	22.5°	0.67	0.95	31
8"	9.45	6.18	2.5	11.75	3/4-10	8	22.5°	0.688	0.95	49
10"	11.25	7.8	2.5	14.25	7/8-9	12	15°	0.866	0.95	76
12"	12.21	9.21	3	17	7/8-9	12	15°	0.866	1.06	112

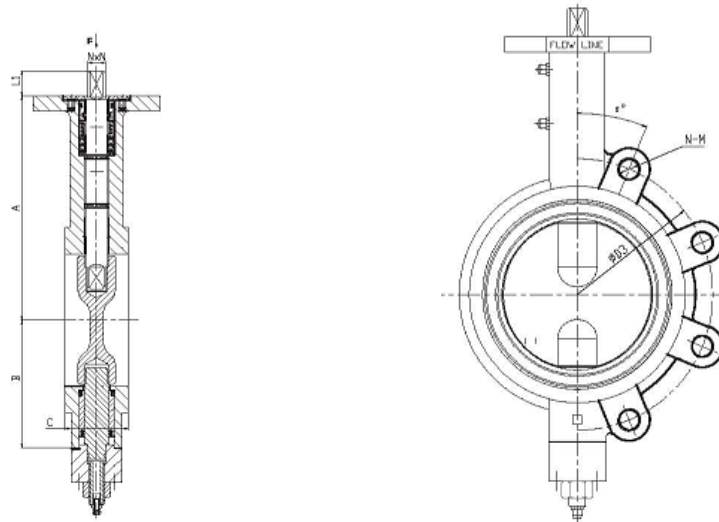

FOR 2'-6" TOP PLATE

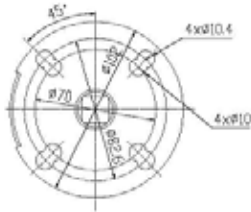

FOR 8"-12" TOP PLATE

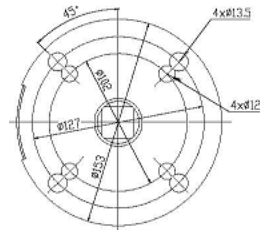

4	stem		
3	disc		
2	seat		
1	body		
Item	Description	Material	Remarks

VALVE SIZE	Wafer/Lug	DIMENSIONAL DATA SHEET METAL SEATED BUTTERFLY VALVE SERIES 74/75 SIZES 2" -12"		PART NO.	
PRESSURE RATING				DRAWING NO.	REV
CUSTOMER/PROJECT				7475-01	
INQ./PO NO.				DATE	
ORDER NO.				12/13/16	
CERTIFIED BY	DATE				

Flow Line Valve and Controls, L.L.C.