

Size	L	D	D1	D2	n-Ød	H	H1	h	K	ISO5211	d1	d2	d3	h1
8"	9.06	16.50	13.75	11.06	12-Ø1.26	9.29	28.15	4.33±.39	1.42	F25	11.81	10.00	7.87	0.20
10"	9.84	20.00	17.00	13.19	16-Ø1.42	11.02	30.12	4.33±.39	1.42	F25	11.81	10.00	7.87	0.20
12"	10.63	22.01	19.25	15.43	20-Ø1.42	12.13	34.25	4.72±.39	1.81	F25	11.81	10.00	7.87	0.20
14"	11.42	23.78	20.75	16.69	20-Ø1.54	12.99	36.22	6.30±.39	2.17	F25	11.81	10.00	7.87	0.20
16"	12.20	27.01	23.75	18.94	20-Ø1.65	14.61	38.19	6.30±.39	2.17	F25	11.81	10.00	7.87	0.20
18"	12.99	29.25	25.75	21.42	20-Ø1.77	15.87	40.55	6.69±.39	2.17	F25	11.81	10.00	7.87	0.20
20"	13.78	32.01	28.50	23.43	24-Ø1.77	17.40	42.52	6.69±.39	2.95	F30	13.78	11.73	9.06	0.20
24"	15.35	37.01	33.00	27.68	24-Ø2.01	19.88	44.49	7.48±.39	2.95	F35	16.34	14.02	10.24	0.20

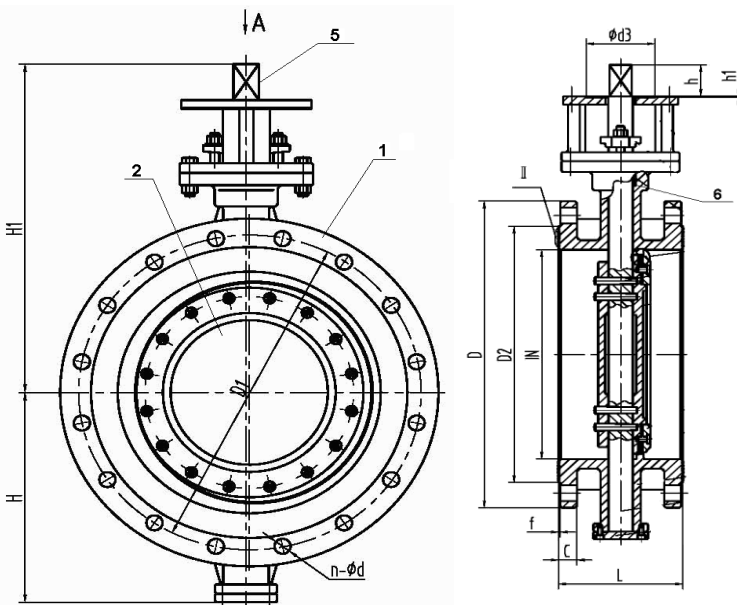

No.	Item	Material	Optional
1	Body	WCB/316SS/304SS	Duplex
2	Disc	316SS/304SS	Stellite/Duplex
3	Seat	.13Cr	Stellite
4	Seat Ring	316SS+Graphoil	Stellite+Graphoil/ 304SS+Graphoil/ .13Cr+Graphoil
5	Shaft	17-4PhSS	316SS/Monel
6	Packing	Graphoil	Consult Factory
7	Bearings	SS+Nitrate	Consult Factory

<b>Design</b>	API 607 6th Edition		
<b>Flange</b>	ANSI B16.5		
<b>Test</b>	API 598		
<b>Torque In-lbs</b>			
<b>8"</b>	47795	<b>16"</b>	167921
<b>10"</b>	61603	<b>18"</b>	270291
<b>12"</b>	74348	<b>20"</b>	403606
<b>14"</b>	100759	<b>24"</b>	584166

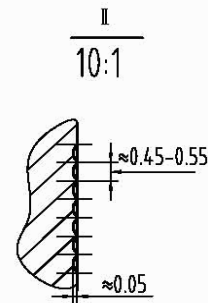
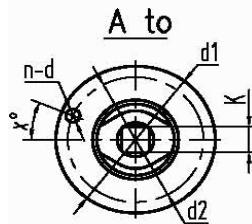
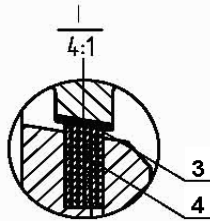

VALVE Flanged Torque Seated Triple Offset	<b>DIMENSIONAL DATA SHEET</b>  <b>Series 78</b> <b>Flanged Torque Seated Triple Offset Butterfly Valve</b>  <b>Size 8" - 24"</b>	PART NO.	
PRESSURE RATING ANSI 600		DRAWING NO. FL78-3600	REV B
CUSTOMER/PROJECT		DATE	
SPECIFICATION API 607 6th Edition		1/31/2013	
CERTIFIED BY J.D. & T.Z.			